

INSTALLATION OPERATION AND MAINTENANCE INSTRUCTIONS BUTTERFLY VALVE

Working temperature 0 °C/120 °C

Suitable for installation between flanges drilled according to PN10 and PN16

WARNING: NEVER PUT HANDS OR ANY OTHER OBJECT IN THE VALVE—SERIOUS INJURIES WILL OCCUR AND VALVE WILL BE DAMAGED.

PRE – INSTALLATION:

Clean and check mating surfaces for possible damages. Butterfly valves are bi-directional and may be installed with flow in either direction. The recommended installation is with the stem in vertical position.

INSTALLATION:

- Check that the distance between flanges matches the face-to-face dimension of the butterfly valve. Before installing the valve, spread the flanges apart sufficiently using a suitable tool, and put the valve in the half opened position.
- Slide the butterfly valve between the opened flanges and insert the flange bolts through the adjusting holes.
- Fully open the valve.
- Tighten the flange bolts hand-tight as the tool holding the flanges apart is removed. Make sure that the flanges remain correctly aligned.
- Slowly close the valve disc and check the adequate closing.
- When the disc is in the “open position”, carefully tighten the bolts around the flange using the prescribed torque.

STORAGE, PROTECTION, OPERATION AND MAINTENANCE

STORAGE AND PROTECTION:

CAUTION: IF THE VALVE IS TO BE STORED FOR A LONG PERIOD OF TIME BEFORE INSTALLATION IT SHOULD BE STORED IN A DRY AND DUST-FREE WAREHOUSE TO PREVENT DAMAGING EFFECTS. KEEP THE VALVE DISC IN A SLIGHTLY OPEN POSITION.

Valves stored for a longer period should be maintained as follows:

- Clean the dirt and grease machined surfaces with some antirust oil at least every 3 months.

OPERATION:

When it is working, the valve has to be fully opened or closed, because the partly closed disc to adjust the flow can prevent the high speed fluid and damage the seal surface.

DISASSEMBLE:

Before disassembly, assure that the pressure is not present in the pipeline.

MAINTENANCE:

Butterfly valves should be actuated at a minimum of once a month to prevent the disc from seizing to the seat. In addition the rubber seat should be inspected periodically for dryness and a light coating of grease should be applied to the seat as required.

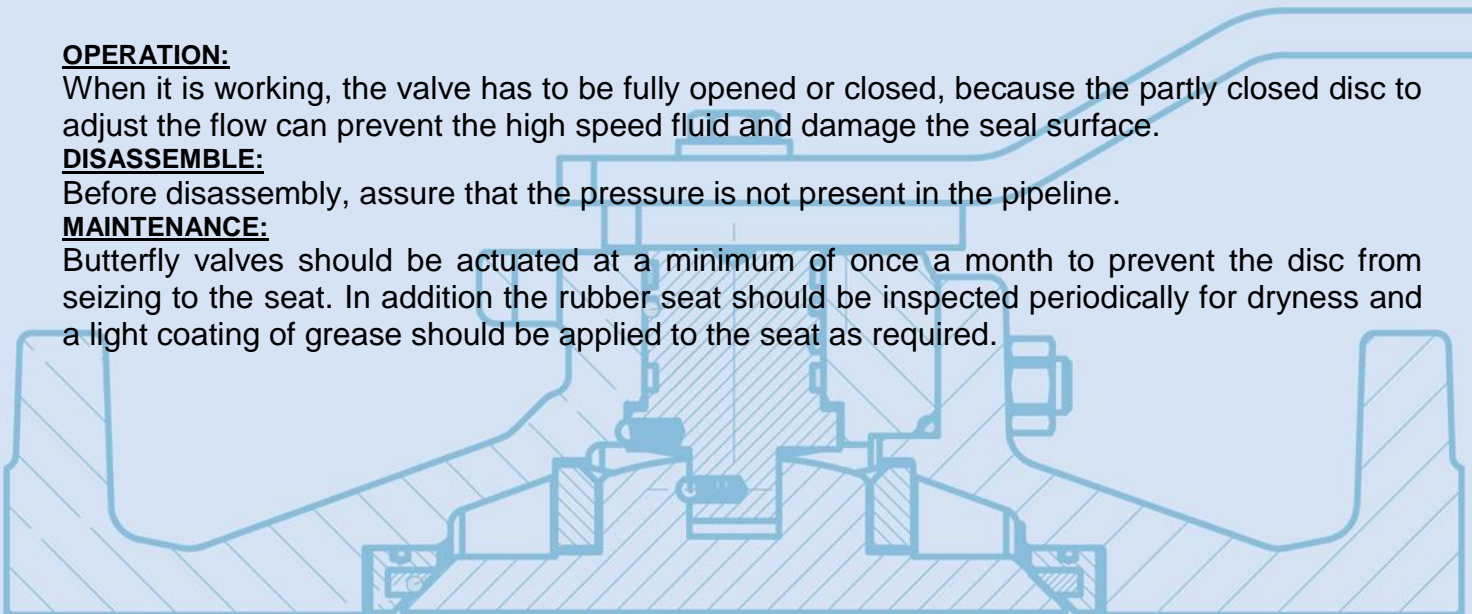

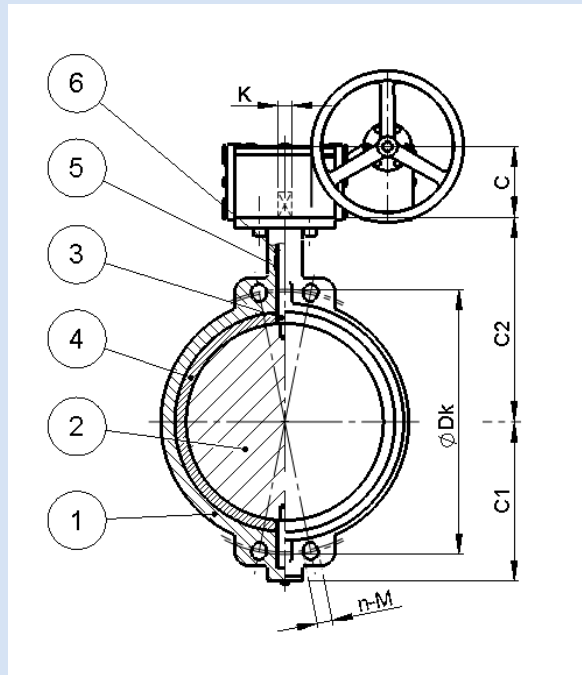
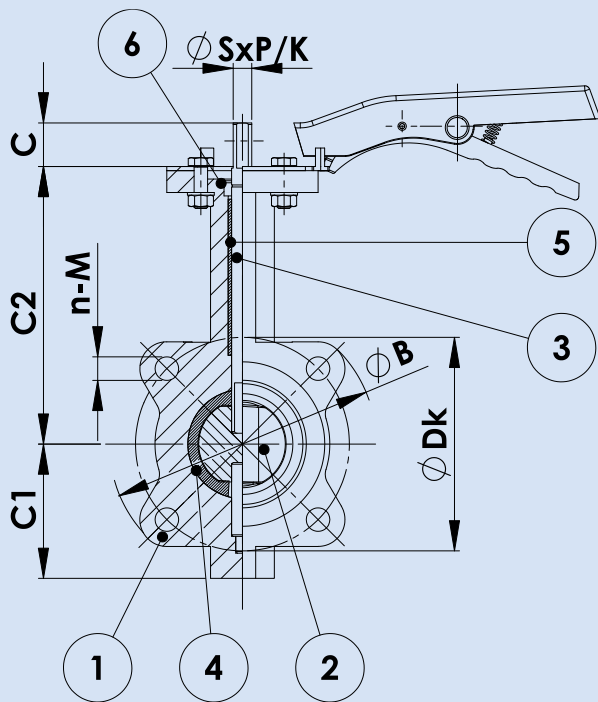

1	Body	Ductile Iron – GGG50
2	Disc	Stainless Steel – A316
3	Stem	Stainless Steel – A304
4	Seat	EPDM
5	Bushing	PTFE
6	O-Ring	EPDM

